

RMI® Parts for Taylor Wharton Style XL 45-50-55 PB-Econo

RMI® RATERMANN
MANUFACTURING, INC.

CROSS

Part # FIT-X14

Cross Brass 1/4 FPT Forged

00



CGA FITTINGS AND DUST CAPS

INERT ARGON/NITROGEN FITTINGS

CGA 580

Part # CGA-58038

Inert Gas 3/8" NPT

1



2 3



CGA 295

Single Item - Part # CGA-29538

(Pkg. of 10 - Part # CGA-29538-PK10)

Inert Vent and Liquid 3/8" NPT

OXYGEN FITTINGS

CGA 540

Part # CGA-54038

Oxygen Gas use

3/8" NPT

1



2 3



CGA 440

Single Item - Part # CGA-44038

(Pkg. of 10 - Part # CGA-44038-PK10)

Oxygen Vent and Liquid use 3/8" NPT

INERT ARGON/NITROGEN DUST CAPS

CGA 580 DUST CAP

Part # CGA-580DC

Dust Cap for Inert Gas use CGA 580

4



CGA 295 DUST CAP

Part # CGA-295DC

Dust Cap for Inert Vent and Liquid

5 6



OXYGEN DUST CAPS

CGA 540 DUST CAP

Part # CGA-540DC

Gas Dust Cap and Chain for CGA 540

4



CGA 440 DUST CAP

Part # CGA-440DC

Oxygen Vent and Liquid use

5 6



Oxygen Safe Valve Leak Check

see page 9A-21 for more info

RMI® Parts for

TAYLOR WHARTON STYLE XL 45-50-55 PB-ECONO

Built Prior to 1998

D.O.T. 4L-200

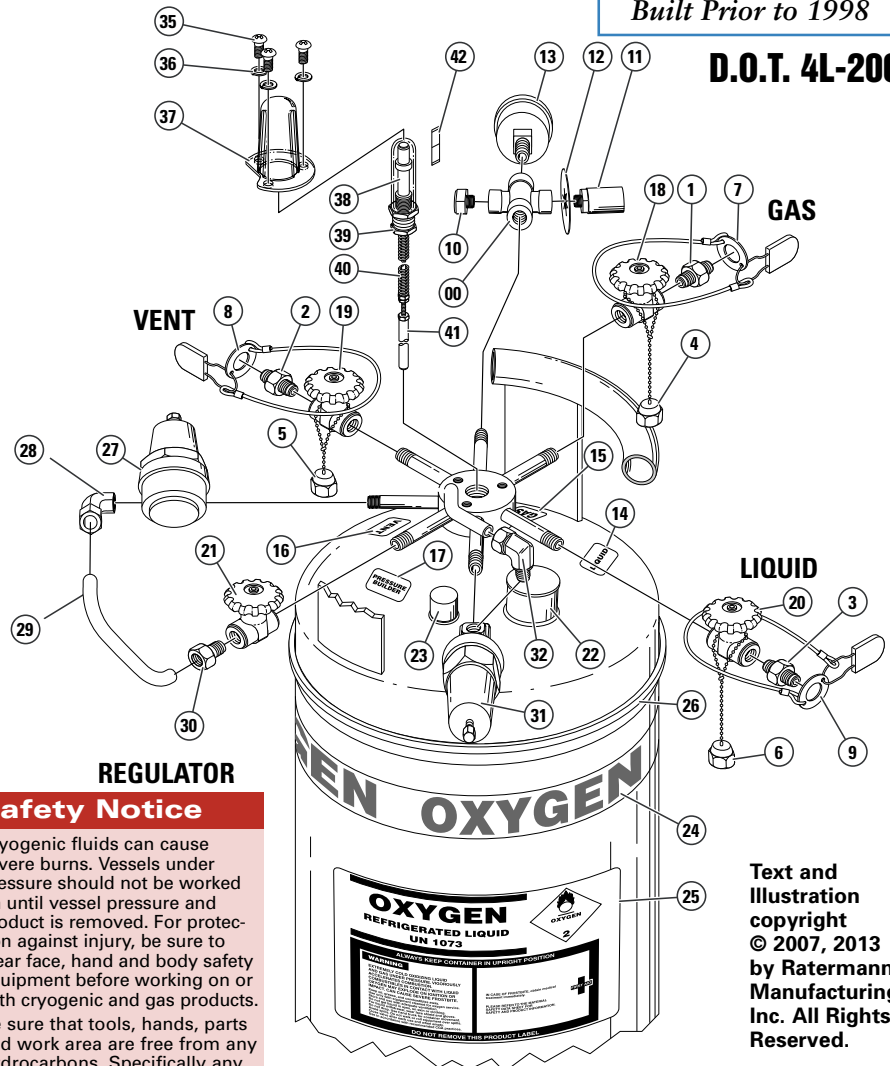

Safety Notice

Cryogenic fluids can cause severe burns. Vessels under pressure should not be worked on until vessel pressure and product is removed. For protection against injury, be sure to wear face, hand and body safety equipment before working on or with cryogenic and gas products. Be sure that tools, hands, parts and work area are free from any hydrocarbons. Specifically any dirt, oil or grease.

Parts must be cleaned for oxygen service if they will be exposed to product.

Taylor-Wharton is a trademark of Taylor Wharton International, LLC. RMI® parts are not licensed, approved or sponsored by the Taylor Wharton International, LLC.

SAFETY WARNING
Nitrile Latex-Free Gloves should be worn at all times when working on Oxygen containers.
Nitrile Latex-Free gloves will NOT give protection from cold or cryogenic liquids.
See page 27A-4 for Nitrile Latex-Free Gloves

Text and Illustration copyright © 2007, 2013 by Ratermann Manufacturing, Inc. All Rights Reserved.

TAMPER DEVICE KITS 7 8 9

Oxygen - 1 Kit

Part # CGP-23

Inert - 1 Kit

Part # CGP-13

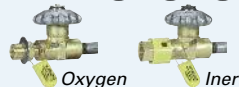

RUPTURE DISC 10

Part # BD-230

Rupture Disc 1/4" NPT



RELIEF VALVE 11

Single Item - Part # LPR-230

(Pkg. of 5 -

Part # LPR-230-PK5)

Relief Valve Brass - 1/4 NPT 230 PSI



PRESSURE RELIEF I.D. DISC 12

Part # DS-230

Color-coded pressure relief I.D. discs are imprinted with the appropriate pressure of safety relief.



GAUGE 13

Part # PG-400

Pressure Gauge 2" Dial 0-400 PSI/BAR/KPA



LABEL LIQUID 14

Part # DL-OL

Decal - Liquid Valve



LABEL GAS

Part # **DL-OG**
Decal – Gas

15

GAS

LABEL VENT

Part # **DL-OV**
Decal – Vent

16

VENT

LABEL PB

Part # **DL-OPB**
Decal – Pressure
Builder Valve

17

**PRESSURE
BUILDER**

GAS USE VALVE

Part # **VR-38F218TB-G**
Green Handle – Valve Brass
GH 3/8 FPT x 3/8 SCH 10
(**VALVE REBUILD KIT Pt # DV-G-RBK1**)

18



VENT USE VALVE

Part # **VR-38F218TB-S**
Silver Handle – Valve Brass
GH 3/8 FPT x 3/8 SCH 10

19



VALVE REBUILD KIT

Single Item – Part # **DV-RBK1**
(Pkg. of 10 – Part # **DV-RBK1-PK10**)

LIQUID USE VALVE

Part # **VR-38F218TB-B**
Blue Handle – Valve Brass
BH 3/8 FPT x 3/8 SCH 10
(**VALVE REBUILD KIT Pt # DV-B-RBK1**)

20



VALVE PRESSURE BUILDER

Part # **VR-38F38F**
Short-stem shut off
valves 3/8" FNPT

21



VALVE REBUILD KIT

Single Item – Part # **DV-RBK1**
(Pkg. of 10 – Part # **DV-RBK1-PK10**)

CAP

Part # **DC-CAP**
Cap Vinyl –
Plastic Blue

22

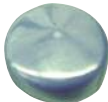

CAP

Part # **PC-M78**
Pumpout Cap

23



**DEWAR 360°
WRAP AROUND TAPE**

Part #'s for Gas Tape:
DG-TO Oxygen
DG-TN Nitrogen
DG-TA Argon

24



Part #'s for Medical Tape:

DG-MEDO Medical Oxygen
DG-MEDN Medical Nitrogen
DG-MEDNO Med Nitrous Oxide



DEWAR LABELS

Part #'s

25
DB-O Oxygen
DB-A Argon
DB-N Nitrogen
DB-USP Oxygen USP
DB-NNF Nitrogen NF
DB-NO Nitrous Oxide

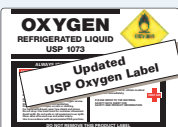

LABEL BUFFER

Part # **LB-D160B** 26
Color coded bands can be used to
identify pressure: Yellow for 22
PSI, Blue for 235 PSI, and gray.



**PRESSURE
BUILDER
REGULATOR**

Part # **CR-125**

27



ELBOW

Part # **FIT-90ECF38M14**
Elbow Brass 90D
3/8 ODT x 1/4 MPT

28



TUBING

Part #
CCT-TA

29



FITTING

Part #
FIT-M38OD38

30



**ECONOMIZER
REGULATOR**

Part # **CE-140**

31



ELBOW

Part # **FIT-90ECF38M14**
Elbow Brass 90D
3/8 ODT x 1/4 MPT

32



SCREW

Part # **CSS-T3**

35



LOCKWASHER

Part # **LC-T3**

36



GAUGE PROTECTOR

Part # **SGP-TFC**

37



LIQUID LEVEL GAUGE

Obsolete

38

You will need a conversion kit to change to the
new style Float Gauge. See **Sight Gauge
Conversion Kit**, circle number 45, on this page.

O-RING Obsolete

You will need a conversion kit to
change to the new style Float Gauge.
See **Sight Gauge Conversion Kit**, circle
number 45, on this page.

39

SPRING Obsolete

You will need a conversion kit to
change to the new style Float Gauge.
See **Sight Gauge Conversion Kit**, circle
number 45, on this page.

40

FLOAT ROD

Part #'s 41
For XL-45 use Pt # **FR-45**
For XL-50/XL-55 use Pt # **FR-5055**

41



DECALS

Part #'s **SG-DA** Argon
SG-DN Nitrogen
SG-DN2O Nitrous Oxide
SG-DO Oxygen

42



**SIGHT GAUGE
CONVERSION KIT**

**SIGHT GAUGE
CONVERSION KIT**

45
For XL-45 use Pt # **LL-RETRO45**
For XL-50/XL-55 use Pt # **LL-RETRO45-9C55**

Includes the following:

46 **SCREW**
Part # **CSS-T3**

47 **WASHER**
Part # **LC-T3**

48 **GAUGE
PROTECTOR**
Part # **SGP-TRC**

49 **LIQUID
LEVEL
GAUGE**
Part #
LL-TW-M450

50 **O-RING**
Part #
SGP-TFC-OR

51 **FLOAT ROD**
Part #'s
For XL-45 use Pt # **FR-45**
For XL-50/XL-55 use Pt # **FR-5055**

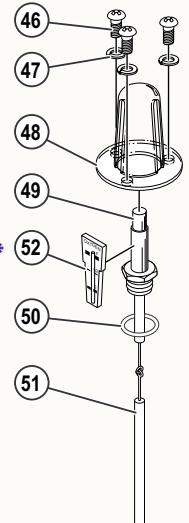

– Sold Separately –

***SNAP ON INDICATOR**

Part #'s **LL-TW-RA** Argon
LL-TW-RN Nitrogen
LL-TW-RNO Nitrous Oxide
LL-TW-RO Oxygen



MEDICAL CGA FITTINGS

TAMPER PROOF DEVICE

This system cannot be removed
without rendering the CGA
outlet connection unusable.



INERT TAMPER PROOF DEVICE

1 **CGA 580** (Gas use)
Pkg. of 5 Single Item
Pt # **TPG-580-PK5** Pt # **TPG-580**

2 **CGA 295** (Vent & Liquid use)
Pkg. of 5 Single Item
3 Pt # **TPG-295-PK5** Pt # **TPG-295**

OXYGEN TAMPER PROOF DEVICE
1 **CGA 540** (Gas use)
Pkg. of 5 Single Item
Pt # **TPG-540-PK5** Pt # **TPG-540**

2 **CGA 440** (Vent & Liquid use)
Pkg. of 5 Single Item
3 Pt # **TPG-440-PK5** Pt # **TPG-440**